

CATALOGUE OF THE PRODUCTS

2014



METAL DOORS

entrance
external

MAR-TOM
metal doors



Multi-business MAR-TOM Sp. z o.o. company based in Jędrzejów is an innovative manufacturer of complete metal doors – glazed and technical along with architrave.

The Company was established in 1999. Since 2000 it has been involved in manufacturing external metal doors of diverse design and colour range. Over the past years, the company has acquired a modern machine – tool park, as well as decided to build a new production hall. The investment was completed in June 2011 and currently it houses the whole of production. Currently, we are one of top manufacturers of metal doors in Poland. The recipients of our commercial offer are mainly domestic partners, however, more and more often foreign customers find us.

Company management is based on Lean Management in which the priority is that the customer receives highest quality product, meeting customer requirements, both with regard to aesthetics, functionality, precision of execution and punctuality of receiving a finished product - exactly on time. Therefore, it is extremely important for us to constantly improve all processes taking place at every stage of production.

Company management is based on Lean Management in which the priority is that the customer receives highest quality product, meeting customer requirements, both with regard to aesthetics, functionality, precision of execution and punctuality of receiving a finished product - exactly on time. Therefore, it is extremely important for us to constantly improve all processes taking place at every stage of production.



Doors produced by the MAR-TOM company filled with slab of foamed hard polystyrene are characterized by perfect parameters of thermal and acoustic insulation.

High quality galvanized steel sheet coated with layers of laminate with woodgrain finish, which is resistant to UV rays and weather conditions as well as modern design cause that, our doors are perceived as a very good external doors suitable for housing development and public utility.



Metal , entrance doors with improved thermal insulation external/internal (thickness 72 mm)
in accordance with standard PN-EN 14351-1:2006+A1:2010

CONSTRUCTION OF THE DOOR:

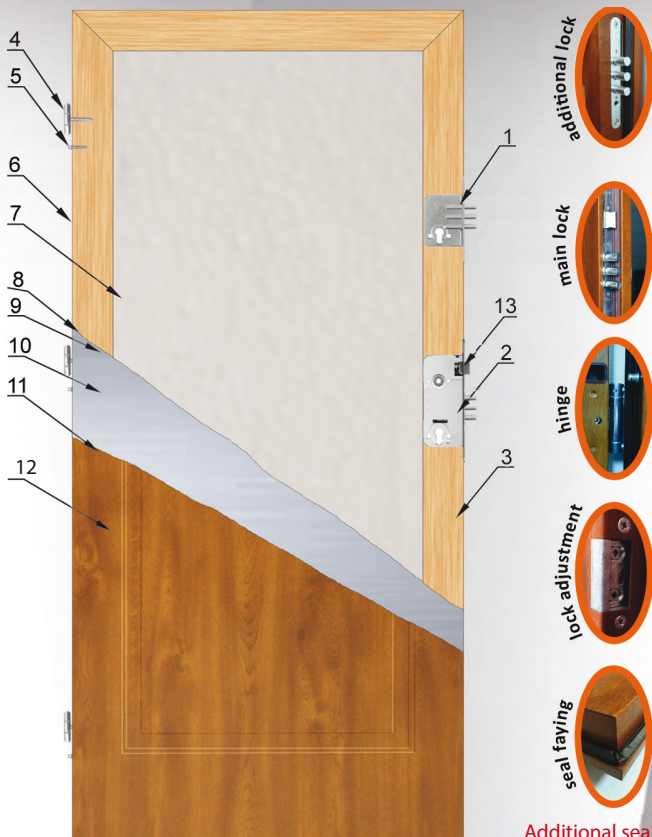

1. Additional lock
2. Main lock
3. Reinforcing slat
4. Tripartite hinges \varnothing 18
5. Bolt protecting against forcing
6. Seal faying
7. Slab of hard polystyrene
8. Glue
9. The zinc coating
10. Steel sheet
11. The zinc coating
12. Laminate with woodgrain finish
13. Lock adjustment

Additional seal in the bottom of the leaf



THE PROFILE OF LEAF - DOOR AND DOOR-FRAME:

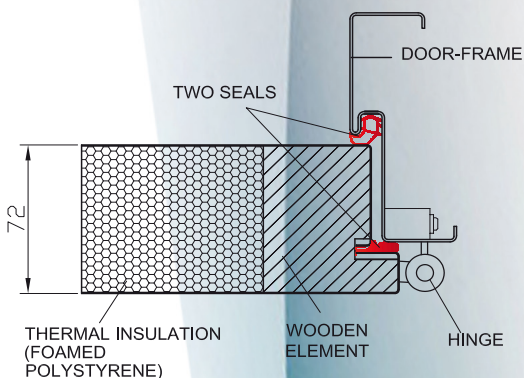

ADOPTION

Doors for the installation in housing development and public utility

- smooth or pressed of steel sheet covered with PVC decorative film, resistant to UV rays,
- filled with slab of foamed hard polystyrene,
- protected against forcing: lower three-bolt lock, upper three-bolt lock and three fixed bolts protecting against forcing,
- two seals on the door circumference: seal of leaf and seal of door frame,
- wooden reinforcing slat on the circuit leaf ,
- structure of hinges for doors opening outside and inside makes it impossible to remove door leaf.

STANDARD EQUIPMENT:

- door leaf in system of 4-sided faying,
- door-frame in the same color like a leaf with seal,
- main three-bolt lock,
- additional three-bolt lock,
- fixed bolts protecting against forcing,
- tripartite hinges \varnothing 18,
- lock adjustment,
- stainless steel threshold.

In the standard equipment of the frame which is available is:

- asymmetric.

ADDITIONAL EQUIPMENT FOR EXTRA CHARGE	
Lock insert 40x55 Lock insert with knob 40x55	„system on one key“ 6.2.C. category
Lock insert 40x55 Lock insert with knob 40x55	„system on one key“ 6.2.B. category
Lock insert 40x55 Lock insert with knob 40x55	„system on one key“
Lock insert 40x55	
Lock insert with knob 40x55	
Handle NIAGARA - AXA	
Handle OTTAWA - AXA	
Handle ZEUS - MAR-TOM	
Bolt/Handle of one-side with NIAGARA - AXA	
Viewfinder	

Heat permeability rate of sash section:

width 900mm complete - 1,0 [W/(m²*K)] width 900 mm glazed - 1,4 [W/(m²*K)]

Attention: Is not possible to reduce the length of door





72 Modern
door leaf, laminated door-frame



72 Modern Silver 92-04
door leaf, laminated door-frame



72 Modern Silver 92-05 Reflex
door leaf, laminated door-frame



72 Modern Silver 92-17 Reflex
door leaf, laminated door-frame



72 Modern Silver 92-18
door leaf, laminated door-frame



72 Modern Silver 92-19
door leaf, laminated door-frame

MODERN SILVER
FLAT EMBOSSED

72 MODERN SILVER

The width of the door: **900 mm**

AVAILABLE COLOURS:

