

MODERN

FLAT EMBOSSED

72 MODERN



72 Modern 92-04
door leaf, laminated door-frame



72 Modern 92-07
door leaf, laminated door-frame



72 Modern 92-13
door leaf, laminated door-frame



72 Modern 92-16
door leaf, laminated door-frame



72 Modern 92-21
door leaf, laminated door-frame



72 Modern 92-24-G1
door leaf, laminated door-frame

The width of the door: **900 mm**

**AVAILABLE
COLOURS:**





72 Smooth
door leaf, laminated door-frame



72 Modern Silver 92-30
door leaf, laminated door-frame



72 Modern Silver 92-31 Reflex
door leaf, laminated door-frame



72 Modern Silver 92-32
door leaf, laminated door-frame



72 Modern Silver 92-33 Reflex
door leaf, laminated door-frame

BOLT/HANDLE FOR THE MODERN AND MODERN SILVER DOORS



circular
arc

straight
rectangular

straight
circular

MODERN SILVER

SMOOTH

72 MODERN SILVER

AVAILABLE COLOURS :



The width of the door: **900 mm**

METAL DOORS

55

**MODERN
MODERN SILVER
VENUS
TITANIUM
ELLIPSE
SMOOTH**

Metal, entrance doors
external/internal (thickness 55 mm)
in accordance with standard PN-EN 14351-1:2006+A1:2010

CONSTRUCTION OF THE DOOR:

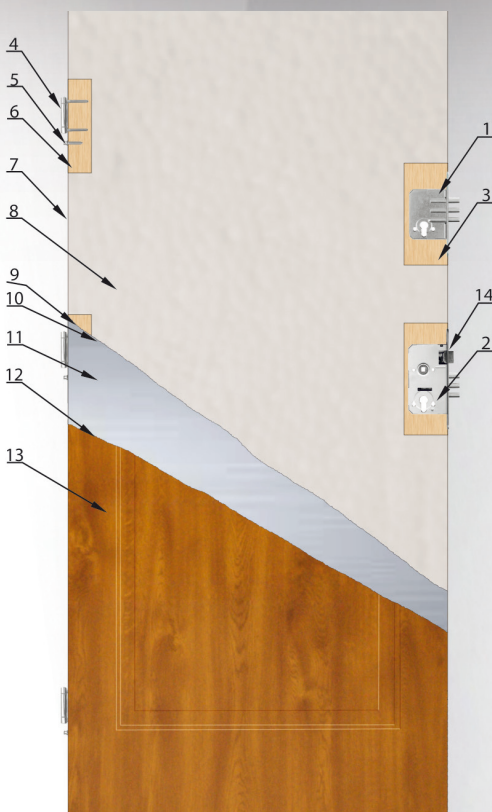

1. Additional lock
2. Main lock
3. Pocket of lock
4. Tripartite hinges Ø16
5. Bolt protecting against forcing
6. Reinforcement for the hinges
7. Seal faying
8. Slab of hard polystyrene
9. Glue
10. The zinc coating
11. Steel sheet
12. The zinc coating
13. Laminate with woodgrain finish
14. Lock adjustment or electric doorstrike



GUARANTEE
24
MONTHS

THE PROFILE OF LEAF – DOOR AND DOOR-FRAME:

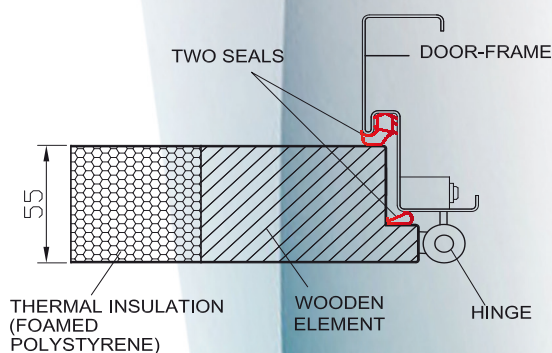

CE

ADOPTION

Doors for the installation in housing development and public utility

- smooth or pressed of steel sheet covered with PVC decorative film, resistant to UV rays,
- filled with slab of foamed hard polystyrene,
- protected against forcing: lower three-bolt lock, upper three-bolt lock and three fixed bolts protecting against forcing,
- two seals on the door circumference: seal of leaf and seal of door frame,
- structure of hinges for doors opening outside and inside makes it impossible to remove door leaf.

STANDARD EQUIPMENT:

- door leaf with seal,
- door-frame in the same color like a leaf with seal,
- main three-bolt lock,
- additional three-bolt lock,
- fixed bolts protecting against forcing,
- tripartite hinges Ø16,
- lock adjustment.

In the standard equipment the frame which is available is:

- asymmetric,
- corner,
- symmetric.

ADDITIONAL EQUIPMENT FOR EXTRA CHARGE	
Lock insert 30x50 Lock insert with knob 30x50	„system on one key“ 6.2.C. category
Lock insert 30x50 Lock insert with knob 30x50	„system on one key“ 6.2.B. category
Lock insert 30x50 Lock insert with knob 30x50	„system on one key“
Lock insert 30x50	
Lock insert with knob 30x50	
Handle NIAGARA - AXA	
Handle OTTAWA - AXA	
Handle KASTOR - MAR-TOM	
Handle ZEUS - MAR-TOM	
Handle PROXIMA - MAR-TOM	
Handle-rail NIAGARA - AXA	
Bolt/Handle of one-side with NIAGARA - AXA	
Special ("WARM") Threshold 80/90/100	
Aluminum Threshold 80/90/100	
Viewfinder	
Electric doorstrike	
Reinforcement for self-door closer	
Reduce the length of door (max170 mm)	

The rate of acoustic insulation – 29 dB

Heat permeability rate of sash section:

width 800 mm complete - 1,3 [W/(m²*K)] width 800 mm glazed - 1,7 [W/(m²*K)]
width 900 mm complete - 1,3 [W/(m²*K)] width 900 mm glazed - 1,6 [W/(m²*K)]
width 1000mm complete - 1,2[W/(m²*K)] width 1000mm glazed - 1,7[W/(m²*K)]

THICKNESS BURGLARPROOF DOORS 55.2

Metal, entrance burglarproof doors
external/internal (thickness 55 mm)
in accordance with standard PN-EN 14351-1:2006+A1:2010
PN-EN 1627:2011

**MODERN
MODERN SILVER
VENUS
TITANIUM
ELLIPSE
SMOOTH**

CONSTRUCTION OF THE DOOR:

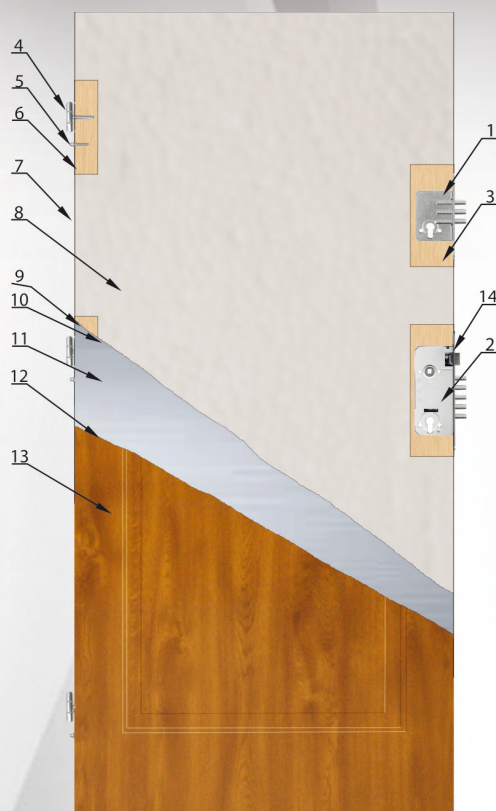

1. Additional lock
2. Main lock
3. Pocket of lock
4. Tripartite hinges Ø18
5. Bolt protecting against forcing
6. Reinforcement for the hinges
7. Seal faying
8. Slab of hard polystyrene
9. Glue
10. The zinc coating
11. Steel sheet
12. The zinc coating
13. Laminate with woodgrain finish
14. Lock adjustment



Burglarproof class



THE PROFILE OF LEAF – DOOR AND DOOR-FRAME:

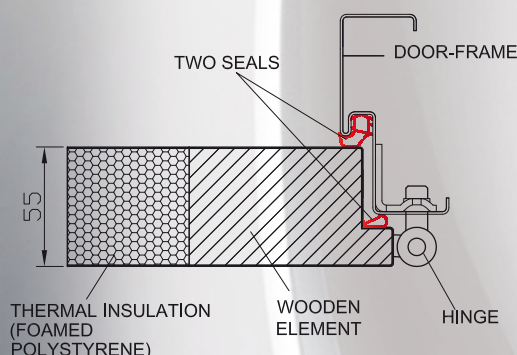

ADOPTION

The adoption of system 11 bolts (8 movable and the 3 fixed), 3 hinge in the best burglarproof quality as well as best material door construction connected with high quality implementation guarantee the high level of security and long-term durability of doors

- smooth or pressed of steel sheet covered with PVC decorative film, resistant to UV rays,
- filled with slab of foamed hard polystyrene,
- protected against forcing: lower five-bolt lock, upper three-bolt lock and three fixed bolts protecting against forcing,
- two seals on the door circumference: seal of leaf and seal of door frame,
- structure of hinges for doors opening outside and inside makes it impossible to remove door leaf.

STANDARD EQUIPMENT:

- door leaf with seal,
- door-frame in the same color like a leaf with seal,
- main three-bolt lock,
- additional three-bolt lock,
- fixed bolts protecting against forcing,
- tripartite hinges Ø18,
- lock adjustment.

In the standard equipment the frame which is available is:

- asymmetric,
- corner,
- symmetric.

ADDITIONAL EQUIPMENT FOR EXTRA CHARGE	
Lock insert 30x50 Lock insert with knob 30x50	„system on one key“ 6.2.C. category
Lock insert 30x50 Lock insert with knob 30x50	„system on one key“ 6.2.B. category
Lock insert 30x50 Lock insert with knob 30x50	„system on one key“
Lock insert 30x50	
Lock insert with knob 30x50	
Handle DIVA - AXA	> 90 <
Handle ORION - MAR-TOM	
Handle-rail NIAGARA - AXA	> 90 <
Bolt/Handle of one-side with NIAGARA - AXA	> 90 <
Special ("WARM") Threshold 80/90/100	
Aluminum Threshold 80/90/100	
Viewfinder	
Reinforcement for self-door closer	
Reduce the length of door (max170 mm)	

The rate of acoustic insulation – 29 dB
Heat permeability rate of sash section:

width 800 mm complete - 1,3 [W/(m²*K)] width 800 mm glazed - 1,7 [W/(m²*K)]
width 900 mm complete - 1,3 [W/(m²*K)] width 900 mm glazed - 1,6 [W/(m²*K)]
width 1000mm complete - 1,2[W/(m²*K)] width 1000mm glazed - 1,7[W/(m²*K)]

To keep the burglarproof certificate in the 2 class PN-ENV 1627:2011 you need to provide door in lock insert of the main lock 6.2.B class or 6.2.C. class as well handle door with secure of the lock insert of main lock.

Burglarproof certificate concern only the doors without glazed!